

PROJECT NAME: SURYAM ANANTA (P-1143)

Suryam Ananta, B/s. Arpan International School, Nr.madhav Farm, S.p Ringroad.



| | |
|---------------------|-------------------|
| Property Type: | Flat/Appartment |
| Builder Name: | Suryam Developers |
| Locality: | Vastral |
| City: | Ahmedabad |
| State: | Gujarat |
| Availability: | 01-06-2024 |
| Project Type: | Ongoing |
| Sample House Ready: | No |

Rera ID: PR/GJ/AHMEDABAD/AHMADABAD CITY/AUDA/MAA06974/110520

Description: 3 BHK Apartments & Retail

Architect Name: Vipul Patel Structure Consultant: CHIRAGKUMAR P NAKRANI

Property Facilities: Kitchen Wash Room Vastu Compliant

| | | | |
|---------------------|---------------------------|---------------------|--------------------|
| Building Amenities: | CCTV Camera | Garden | Fire Safety |
| | Visitor Parking | Lift | Power Backup |
| | Security | Library | Multi Purpose Hall |
| | House Keeping | Borewell | Kid's Play Area |
| | Games Room | Waste Disposal | Vastu Compliant |
| | Boom Barrier | Jogging Track | Water Lilly Pond |
| | Pick up and Drop off Zone | Senior Citizen Area | Entrance Foyer |
| | Gated Community | | |

Specification:

| | |
|-------------------|---|
| Structure : | Earth-Quake Resistance RCC Frame Structure with Sandrace Light-Weighted Block Wall. |
| Interior Walls : | Internal Single coat mala plaster with base putty finish and external double coat plaster with acrylic texture & Tully acrylic paint. |
| Flooring : | Vitrified tiles flooring in living, dining, kitchen, bedrooms and all other areas. |
| Electrical : | Three phase concealed copper wiring with good quality accessories with surciant electric points. |
| Kitchen : | Mirror-polished granite platform with glazed tiles dedo up to lintel level and SS. Sink. |
| Wash Area : | Water 24 hour water supply by common bore well to over head water tank by pressure pump. |
| Doors & Windows : | Decorative main entrance door with wooden frame & all other doors will be wooden/granite framed flush door shutters with lock All windows will be made of powder coated aluminium sections. |
| Bathrooms : | Designer superior quality glazed tiles flooring and dedo up to lintel level. |
| A.c. : | Provision for A.C. compressor. |
| Plumbing : | Concealed center point plumbing adequate points with standard fittings. |

PROJECT DETAILS

| | | | | |
|---------|-------|-------------------------|-----------|---------|
| Sr. No. | Type | Constructed Area (SBA) | Area Unit | Parking |
| 1 | 3 BHK | 1378 sqft super builtup | Sq. Ft. | 1 |

- Stamp duty, Registration charges, Legal charges, Auda, Electricity, Corporation, Parking and all other extra charges shall be borne by the purchaser.
- GST, TDS and any other taxes levied in future shall be borne by the purchaser.

PROPERTY PHOTOS

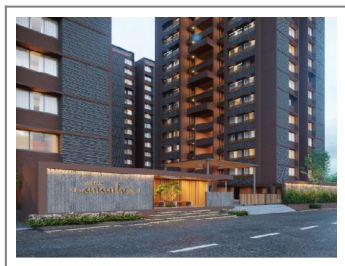
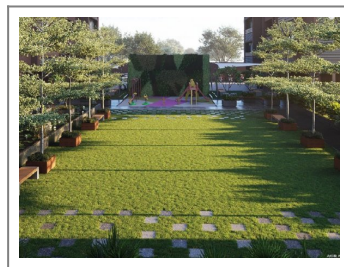
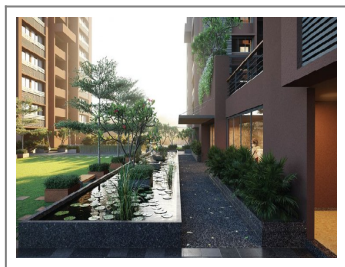

Note : All visuals, images, facilities and other details shown here are for presentation only and are subject to change by the builder/developer/owner without any obligation.

Disclaimer : onestopproperty.in is a online Real Estate platform for Seller and Agent/Broker/Customer/Buyer to facilitate their real estate needs. One Stop Property cannot control any transactions between the Seller and the Agent/Broker/Customer/Buyer. Properties details displayed on the onestopproperty.in website are for informational purposes only. Information regarding real estate projects including property/project details, by various Builder(s)/Developer(s)/Broker(s) who have advertised their property/project. Nothing contained herein shall be deemed to constitute legal advice, solicitations, marketing, offer for sale, invitation to offer, invitation to acquire by the developer/builder or any other entity. One Stop Property Solutions Pvt Ltd shall neither be responsible nor liable to mediate or resolve any disputes or disagreements between the Seller and Agent/Broker/Customer/Buyer. Hereby we strongly advised to visit the relevant RERA website before taking any decision based on the contents displayed on the website.